

REVISION	DESCRIPTION	REVISED BY	DATE
A	First release	Saxon	05/28/2018
B	Update parts from item 36 to item 93.	Jason Xiao	10/08/2018

ITEM	Part Number	DESCRIPTION	Quantity	Remark
92	24.0096.1	EM3B WIRING HARNESS PCB	1	
93	24.0096.0	EM3B WIRING HARNESS MOTOR	1	

91	00.0002.10	SCREW M3X10	2	
90	24.0066.0	SPRING HOLDER	2	
89	24.0014.4	SCREW M4X20 PAN HEAD,CROSS,STAINLESS	2	
88	04.0048.0	NUT M5 NYLON	2	
87	72.0261.0	WHITE CASTOR + BLUE RACKET	2	
86	72.0261.0	NUT M4 NYLON STAINLESS	2	
85	24.0062.0	SPRING 9X28.5MM WIRE DIAMTER 1MM	2	
84	24.0059.0A	EM3 BUSH	2	
83	24.0060.0	WHEEL BRACKET LEFT	1	
82	72.0027.3	SHAFT TRANSPORT CASTOR[V2]	2	
81	24.0061.0	WHEEL BRACKET RIGHT	1	
80	24.0069.0	EM3B MOTOR SUPPORTING STUD	2	
79	24.0020.0	SHAFT SUPPORT BRACKET	2	
78	24.0021.0	WASHER OF SHAFT SUPPORT BRACKET	2	
77	24.0022.0	PLASTIC SLEEVE BEARING	2	
76	24.0023.1	SHIM STEEL	2	
75	24.0023.0	SHIM PLASTIC	2	
74	00.0109.2	WASHER ID10XOD28X2.5	1	
73	73.0002.797	PVC VLUMPER C06/9,Kleur:Blue.797(P312C)	1	
72	24.0034.0	DRIVE DISK	1	
71	00.0121.2	SCREW M4X12	4	
70	24.0027.0	HOLDER OF BEARING	1	
69	24.0028.0	CONNECTION PART DRIVER CONSTRUCTION	1	
68	24.0026.0	BEARING	1	
67	24.0029.0	WASHER BEARING	1	
66	24.0031.0	M8X16 SCREW	1	
65	24.0030.0	DRIVER PLATE	1	
64	55.0027.0	M8X16 SOCKET BUTTON HEAD SCREW GR 10.9 (71552)	1	
63	24.0025.0	COUNTER SUNK SCREW M6X19	2	
62	24.0088.0	SHOCK ABSORBING RING FOR MOTOR	1	
61	72.0033.1	COUNTER SUNK HEAD CAP SCREW M6X12 WITH	4	
60	24.0018.3	MOTOR DC24V 250W	1	
59	24.0100.0	OVER-LOAD PROTECTOR 10A WITH WATERPROOF COVER	1	
58	24.0087.0	SHOCK ABSORBER OD25 X H20 X M6	4	
57	24.0085.0	EM3B MOTOR SUPPORTING PLATE	1	
56	24.0086.0	EM30B WEIGHT	1	
55	67.0181.0	NYLON INSERT NUT M6 SS	7	
54	24.0094.0	EM3 FIXING PIN LOCKER	1	
53	24.0090.0	PLAIN WASHER ID13 X OD20 X T2	1	
52	24.0093.0	EM3B FIXING PING (WITH 1X NUTS & 1X TOOTH WASHER)	1	
51	24.0019.0	HOLDER OF SHAFT SUPPORT BRACKET	2	
50	24.0015.1	MOTOR HOUSING FOR WHEEL	1	
49	24.0056.0	METAL POST	1	
48	25.0032.31	SCREW M5 X 12 STAINLESS	12	
47	24.0016.797	ROTO COVER [BLUE]	1	
46	89.0467.0015.05P	STICKER I-Scrub 30 EASY MOTION Pro [New Base]	1	
45	S.97.0039.9/EM3	WATERPUMP COMPLETE W/IT HOSE + NOZZLE +CORD EASY MOTION	1	
44	24.0078.0	EM3B WATER TANK 1.9L	1	
43	90.2306.0	WHITE WASHER(20003-4-01)	1	
42	90.2304.797	CAP(20003-4). BLUE .797(P312C)	1	
41	97.0043.0	BREATHING VALVE	1	
40	24.0012.1	SUPPORT BRACKET HANDLE WITH FIX BLOCK	1	
39	67.0171.1	HEXAGON SOCKET SCREW M6x50 STAINLESS	1	
38	24.0091.0	EM30B HANDLE SUPPORTING PIN	1	
37	00.0106.2	WASHER 12X6X0.8MM STAINLESS STEEL	5	
36	80.0000.36	HEXAGON DOMED CAP NUTS	1	
35	24.0092.0	EM3B HANDLE RUBBER SLEEVE	1	
34	24.0077.0	EM3B TUBE CLIP SLEEVE	1	
33	00.0068.0	SCREW M5 x 6 HEXACON SOCKET SET SCREW	1	
32	24.0076.0	EM3B TUBE CLIP	1	
31	24.0013.0	CABLE INSERT	3	
30	24.0007.0	DC CONNECTOR2.5	1	
29	97.2018.1	NYLON CAP NUT M5 BLACK	1	
28	00.0195.0	NUT M5 STAINLESS STEEL	1	
27	97.0002.797	HOLDER WATERTANK EASY SCRUB (910100), Kleur:Blue.797(P312C)	1	
26	04.0103.2	THUMB SCREW M5X38	1	
25	24.0095.0	EM3B NAME PLATE	1	
24	24.0079.0	EM3B CONTROL BOX REAR COVER	1	
23	72.0057.0	SCREW WN 5451 25x10 EJOIT DELTA PT [MCH 1416-1001-2150]	1	
22	24.0082.0	EM3B CONTROL PCB	1	
21	00.0000.9	PH SELF-TAPPING SCREW ST4.2x20	10	
20	24.0080.0	EM3B PCB MOUNTING BASE	1	
19	00.0104.0	PH SELF-TAPPING SCREW ST4.2x8	2	
18	72.0235.0	M5 WASHER STAINLESS STEEL 5X15X1MM	2	
17	72.0068.357	BATTERY CONNECTOR MALE Left/Blue / Right:grey	1	
16	24.0081.0	EM3B CONTROL BOX FRONT COVER	1	
15	24.0083.0	EM3B INDICATING PCB	1	
14	72.0060.1	POWER SWITCH CONTROL UNIT 16A	1	
13	24.0043.0	SPRING SWITCH LEVER	1	
12	72.0063.797	HANDLE CONTROL UNIT [MCH 1416-1001-2065],Kleur:Blue.797	1	
11	00.0002.61	SCREW M3X12 SELF TAPING STAINLESS	5	
10	24.0004.0	HANDLE COVER REAR,Kleur: Black	1	
9	73.0002.3	SCREW ST5.05 X 16	4	
8	04.0009.1	PUSH SWITCH 2P BLACK	1	
7	24.0003.0	HANDLE COVER MIDDLE,Kleur: Black	1	
6	04.0009.30	SWITCH 4P LIGHT GREEN OIL	1	
5	24.0075.0	EM3B LONG HANDLE 790MM	1	
4	72.0230.357	HANDLE GRIP WITHOUT PROTRUSION,Kleur: Grey.357(P431C)	2	
3	72.0233.797	END CAP GRIP WITHOUT LOGO,Kleur:Blue.797 (P312C)	2	
2	24.0002.0	HANDLE COVER FRONT,Kleur:Black	1	
1	89.0467.0015.05P	WTICKER I-VAC EASY MOTON PRO (New Handle)	1	
ITEM	Part Number	DESCRIPTION	Quantity	Remark

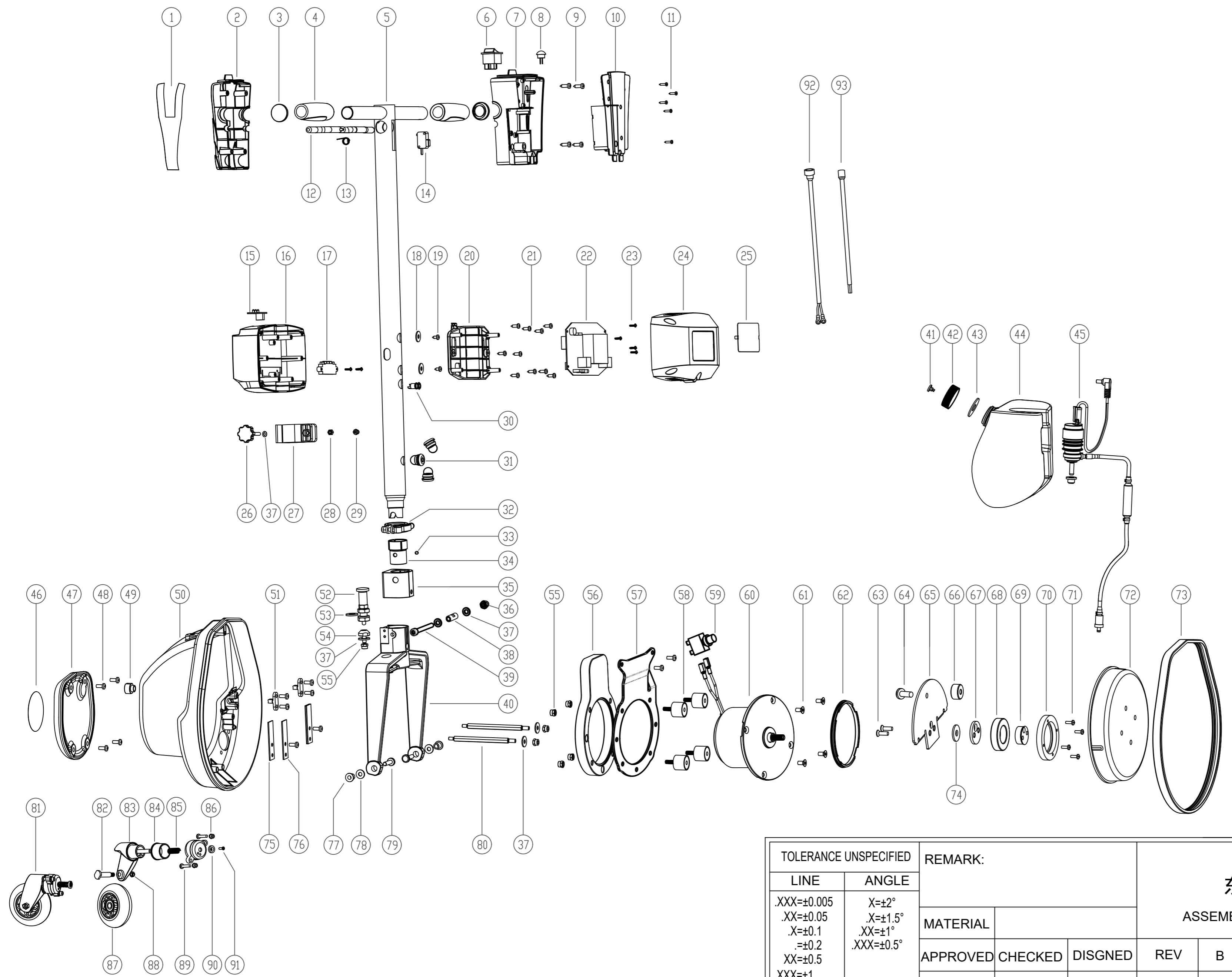

TOLERANCE UNSPECIFIED		REMARK:		<p style="text-align: center;">S M T - C S T D O N G G U</p> <p style="text-align: center;">东莞硕能塑胶模具有限公司</p> <p style="text-align: center;">ASSEMBLY AND MOULDING OF CLEANING PROUDCTS</p>							
LINE	ANGLE	MATERIAL									
.XXX=±0.005	X=±2°			APPROVED	CHECKED	DISGND	REV	B	PART NAME	Assembly drawing for EM30 Pro-B	
.XX=±0.05	.X=±1.5°					Saxon	UNIT	MM	PART NO	EM30 PB	
.X=±0.1	.XX=±1°						SCALE		DRAWING NO		A3
.=±0.2	.XXX=±0.5°										
XX=±0.5											
XXX=±1											
XXX=±2											
SHEET 1 OF 1	DATE					2018.05.15					